

DTX9-BS

Specifications

Model NO .	DTX9-BS	
Upgrade From	YTX9-BS	
Nominal Voltage	12V	
Rated Capacity (10 hours rate)	8 Ah	
Dimensions	Length	150 mm (5.91 inches)
	Width	87 mm (3.43 inches)
	Height	105 mm (4.13 inches)
	Total Height	105 mm (4.13 inches)
Approx. Weight W/O . ACID	2.31 kg (5.09 Lbs)	
Approx. ACID Per Battery	0.45 L	
Charge Current (A)	0.8A (14.4V constant voltage charge)	

Characteristics

Capacity 25°C(77°F)	10hours rate (0.8 A to 10.5V)	8.0Ah
	5hours rate (1.6 A to 10.2V)	6.8Ah
	1C (8.0 A to 9.6V)	3.6Ah
	3C (24.0A to 9.6V)	2.9Ah
Cold Cranking Amperes(-18°C SAE Standard)	90 A	
Cold Cranking Amperes(-18°C EN Standard)	90 A	
Internal Resistance (at 1KHz)	Approx .12mΩ	
Operating Temperature Range	Charge	0°C (32°F) to 40°C (104°F)
	Discharge	-30°C (-22°F) to 50°C (122°F)
	Storage	-15°C (5°F) to 40°C (104°F)
Life Expectancy (Cycle Use)	60% depth of discharge 250 cycles	
	30% depth of discharge 400 cycles	
Charge Retention (self-discharge life) at 20°C (68°F)	1 month	85%
	3 month	80%
	6 month	75%
Warranty	1 year	
Case Material	PP	



Dimensions

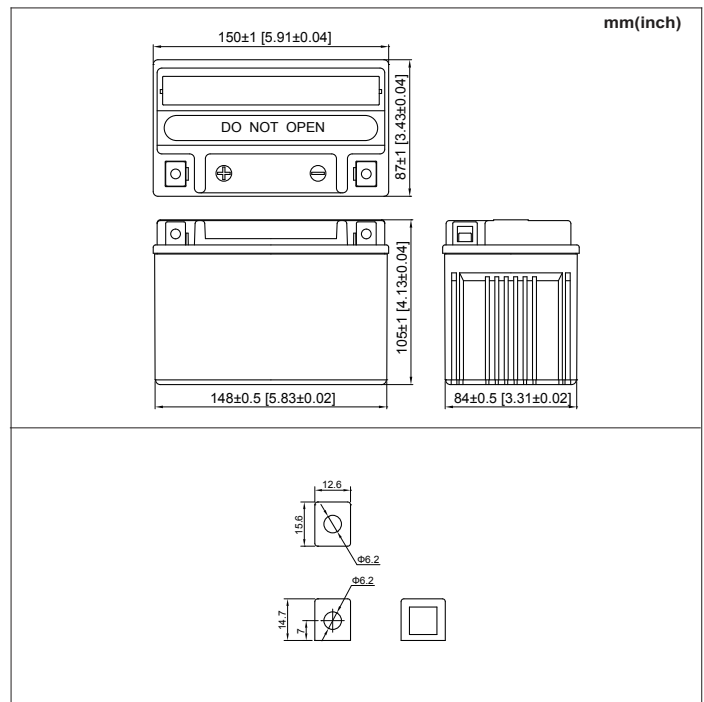

(V) FOR 12V BATTERY

Discharge Time VS. Discharge Current(25°C)

