

DTX7A-BS

Specifications

Model NO .	DTX7A-BS	
Upgrade From	YTX7A-BS	
Nominal Voltage	12V	
Rated Capacity (10 hours rate)	6 Ah	
Dimensions	Length	150 mm (5.91 inches)
	Width	87 mm (3.43 inches)
	Height	93 mm (3.66 inches)
	Total Height	93 mm (3.66 inches)
Approx. Weight W/O . ACID	1.97 kg (4.34 Lbs)	
Approx. ACID Per Battery	0.36 L	
Charge Current (A)	0.6A (14.4V constant voltage charge)	

Characteristics

Capacity 25°C(77°F)	10hours rate (0.6 A to 10.5V)	6.0Ah
	5hours rate (1.2 A to 10.2V)	5.1 Ah
	1C (6.0 A to 9.6V)	2.7Ah
	3C (18.0A to 9.6V)	2.2Ah
Cold Cranking Amperes(-18°C SAE Standard)	85 A	
Cold Cranking Amperes(-18°C EN Standard)	85 A	
Internal Resistance (at 1KHz)	Approx. 12mΩ	
Operating Temperature Range	Charge	0°C (32°F) to 40°C (104°F)
	Discharge	-30°C (-22°F) to 50°C (122°F)
	Storage	-15°C (5°F) to 40°C (104°F)
Life Expectancy (Cycle Use)	60% depth of discharge 250 cycles	
	30% depth of discharge 400 cycles	
Charge Retention (self-discharge life) at 20°C (68°F)	1 month	85%
	3 month	80%
	6 month	75%
Warranty	1 year	
Case Material	PP	



Dimensions

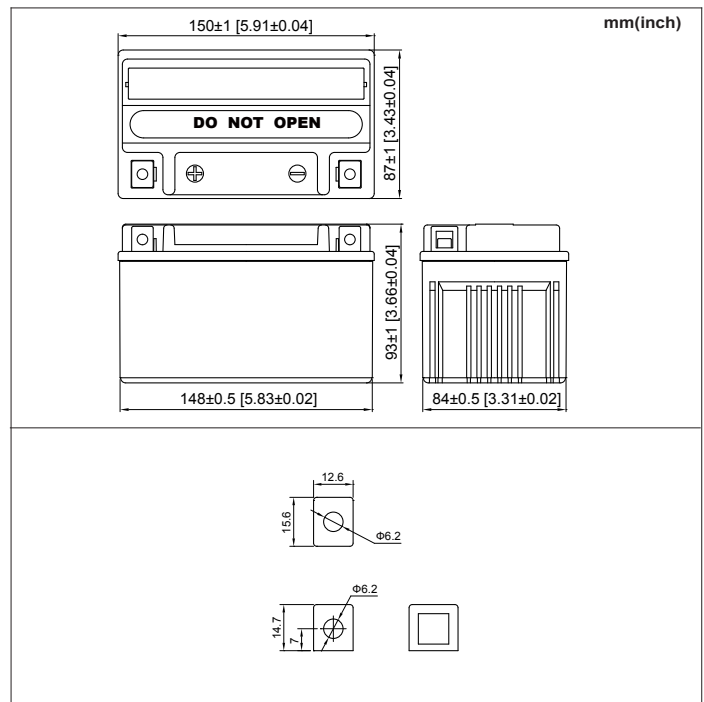

(V) FOR 12V BATTERY

Discharge Time VS. Discharge Current(25°C)

