

# DB10L-A2

## Specifications

|                                |                                       |                      |
|--------------------------------|---------------------------------------|----------------------|
| Model NO .                     | DB10L-A2                              |                      |
| Upgrade From                   | YB10L-A2                              |                      |
| Nominal Voltage                | 12V                                   |                      |
| Rated Capacity (10 hours rate) | 11Ah                                  |                      |
| Dimensions                     | Length                                | 134 mm (5.28 inches) |
|                                | Width                                 | 90 mm (3.54 inches)  |
|                                | Height                                | 145mm (5.71 inches)  |
|                                | Total Height                          | 145 mm (5.71 inches) |
| Approx. Weight W/O . ACID      | 2.70kg (5.95 Lbs)                     |                      |
| Approx. ACID Per Battery       | 0.72 L                                |                      |
| Charge Current (A)             | 1.1 A (14.4V constant voltage charge) |                      |

## Characteristics

|   |                                   |                               |
|---|-----------------------------------|-------------------------------|
| Capacity 25°C(77°F)                                   | 10hours rate (1.1 A to 10.5V)     | 11.0 Ah                       |
|   | 5hours rate (2.2 A to 10.2V)      | 9.4 Ah                        |
|   | 1C (11.0A to 9.6V)                | 5.0 Ah                        |
|   | 3C (33.0 A to 9.6V)               | 4.0 Ah                        |
| Cold Cranking Amperes(-18°C SAE Standard)             | 140 A                             |                               |
| Cold Cranking Amperes(-18°C EN Standard)              | 140 A                             |                               |
| Internal Resistance (at 1KHz)                         | Approx .10mΩ                      |                               |
| Operating Temperature Range                           | Charge                            | 0°C (32°F) to 40°C (104°F)    |
|   | Discharge                         | -30°C (-22°F) to 50°C (122°F) |
|   | Storage                           | -15°C (5°F) to 40°C (104°F)   |
| Life Expectancy (Cycle Use)                           | 60% depth of discharge 250 cycles |                               |
|   | 30% depth of discharge 400 cycles |                               |
| Charge Retention (self-discharge life) at 20°C (68°F) | 1 month                           | 85%                           |
|   | 3 month                           | 80%                           |
|   | 6 month                           | 75%                           |
| Warranty  | 1 year                            |                               |
| Case Material   | PP                                |                               |



## Dimensions

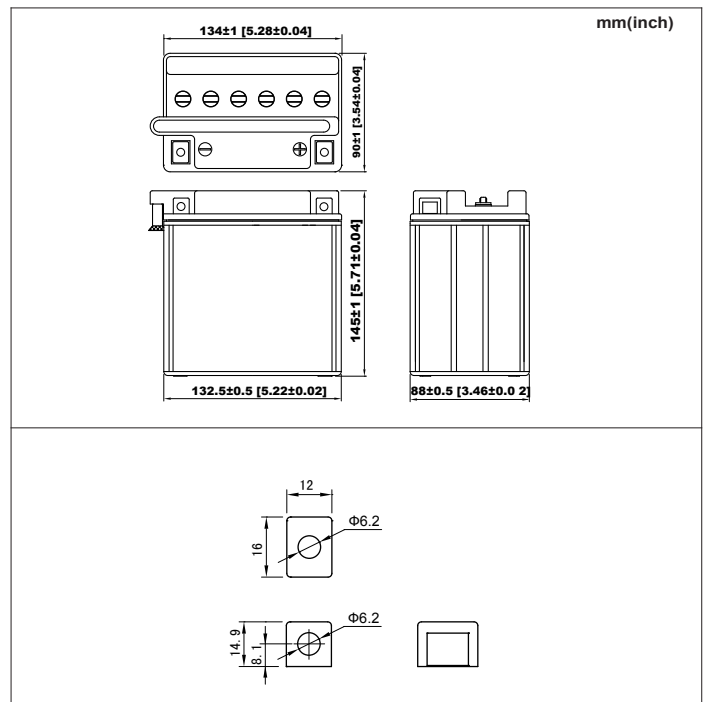

(V)  
FOR 12V  
BATTERY

## Discharge Time VS. Discharge Current(25 °C)

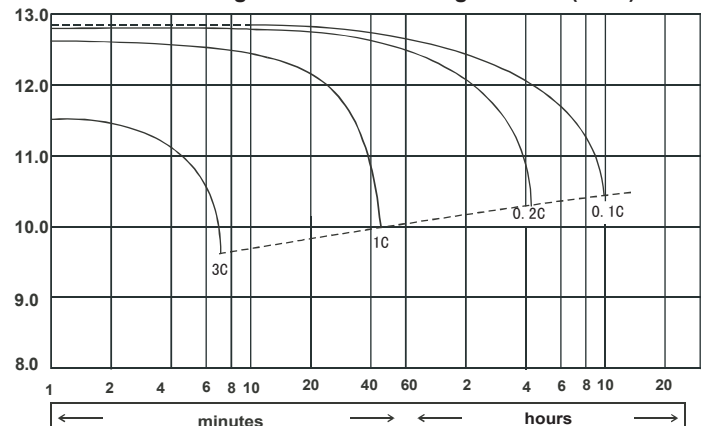

Discharge Time